



# TRIPANE

## TRP | SUSPENDED, SURFACE

### STANDARD SIZES

2.8" Aperture with Reveal (3-Sided) Lens  
Configurable in individual straight run sections

### LAMPING

LED - 80/90 CRI - 3000K/3500K/4000K  
Output Options: LOW/MED/HI/DECOR/Tunable White/RGB/RGB+W  
Dimming down to 0%

### FINISH

Aluminum, White, Black, Silver, Brass, RAL Classic Colors

### CONSTRUCTION

Industrial Strength Extruded 6061 Aluminum





# PRODUCT SUBMITTAL WORKSHEET

## SAMPLE PRODUCT CODE

TRPSD – S5 – HI/90/3500 – 0/10V/0% – LENS – AL – UNV – EMB/1 – OS/1 – COMBO – SB  
1 2 3 4 5 6 7 8A 8B 8C

### 1. BASE MODEL (CHOOSE ONE)

- TRPSD** 2.8" W x 2.9" H – suspended, direct with remote driver
- TRPSMB** 2.8" W x 2.9" H – surface mount, direct with remote driver
- TRPSDINT** 2.8" W x 3.5" H – suspended, direct with integral driver
- TRPSMBINT** 2.8" W x 3.5" H – surface mount, direct with integral driver

*\*Integral driver models feature a taller housing constructed of sheet metal. Remote driver models have a shorter, extruded aluminum housing. See page 4 for more details.*

### 2. LENGTH (ENTER LENGTH IN FEET)

- S\_\_** Individual/Straight Run Section (enter length greater than 2ft, ex. S5)

*\*Lengths are nominal and may vary based on lamping and other specification selections. Consult ALW when exact lengths are required.*

### 3. LED LAMPING (CHOOSE ONE UNDER A, B, & C, AS NECESSARY)

- |   |   |  |
|---|---|--|
| <b>A. OUTPUT</b><br><input type="checkbox"/> <b>LOW</b><br><input type="checkbox"/> <b>MED</b><br><input type="checkbox"/> <b>HI</b><br><input type="checkbox"/> <b>DECOR</b><br><input type="checkbox"/> <b>TUNE</b><br><input type="checkbox"/> <b>RGB</b><br><input type="checkbox"/> <b>RGBW</b> (80CRI, 4000K White) | <b>B. CRI<sup>1</sup></b><br><input type="checkbox"/> <b>80</b><br><input type="checkbox"/> <b>90</b> | <b>C. CCT<sup>2</sup></b><br><input type="checkbox"/> <b>3000K</b><br><input type="checkbox"/> <b>3500K</b><br><input type="checkbox"/> <b>4000K</b> |
|---|---|--|

DELIVERED LUMENS (LM/FT)	WATTS (W/FT)	EFFICACY (LM/W)
See page 5 for complete details.		Up to 74 lm/W

<sup>1</sup>CRI not applicable for DECOR, TUNE, RGB, or RGBW lamping

<sup>2</sup>CCT not applicable for TUNE, RGB, or RGBW lamping

### 4. DRIVER (CHOOSE ONE)

- 0/10V/S** 0-10V dimming down to 5% (Standard Dimming – Down to 10% for DECOR and TUNE lamping)
- 0/10V/1%** 0-10V dimming down to 1%
- 0/10V/0%** 0-10V premium dimming down to 0%
- DALI** DALI flicker-free dimming down to 0%
- DMX** DMX flicker-free dimming down to 0% (Recommended for RGB or RGBW lamping)
- ECOSYS1** Lutron Hi-Lume 1% EcoSystem, constant current or constant voltage
- ECOSYS5** Lutron 5-Series 5% EcoSystem, constant current (Not available with DECOR or TUNE lamping)

*\*Driver specifications provided upon request to assist with control system integration.*

### 5. LENS

- LENS** Extra diffuse, 3-sided lens



---

## 6. FINISH (CHOOSE ONE)

- AL** Natural Anodized Aluminum (Standard Finish)
- BK** Black Powder Coat
- BRS** Brass Metallic Powder Coat
- SV** Silver Powder Coat
- WH** White Powder Coat
- WH/AM**  White Antimicrobial Powder Coat (for healthcare environments)
- RAL\_\_\_\_\_** Specify RAL Classic Color code (ex: RAL3003) [ralcolorchart.com/ral-classic](http://ralcolorchart.com/ral-classic)

---

## 7. VOLTAGE (CHOOSE ONE)

- UNV** Universal Voltage (120VAC-277VAC)
- 347** 347 Volt (*Driver options may be limited*)

---

## 8. ADDITIONAL OPTIONS (OPTIONAL – CHOOSE ONE UNDER A & B, AND ANY UNDER C, IF DESIRED)

### A. EMERGENCY OPTIONS

- EMB/\_\_\_<sup>3</sup>** Emergency Battery (*indicate quantity – each battery powers 4ft with a delivered lumen output of 1404lm*)
- EMC/\_\_\_<sup>3</sup>** Emergency Circuit (*indicate quantity of 4ft sections to be illuminated by emergency circuit*)

<sup>3</sup>For fixtures under 4ft in length, entire fixture will be illuminated with a proportional lumen output. Consult ALW for available options.

### B. SENSOR OPTIONS (COMPATIBLE ONLY WITH 0-10V DRIVERS – INDICATE SPECIFIC QTY IF DESIRED, OTHERWISE QTY WILL BE AUTOMATICALLY CALCULATED)

- ENLGH/\_\_\_<sup>4</sup>** Enlighted® remote smart sensor (*occupancy, daylight, networking, and more*)
- OS/\_\_\_** 0-10V remote occupancy sensor
- PH/\_\_\_** 0-10V remote photocell/daylight sensor

<sup>4</sup>Enlighted® Gateway *and* Energy Manager (by others) plus programming required. Learn more at [enlightedinc.com](http://enlightedinc.com).

### C. ADDITIONAL OPTIONS (COMPATIBLE ONLY WITH SUSPENDED MOUNT)

- COMBO** Combination 4.5" canopy at power feed locations to accommodate both power cord & suspension mount hardware.
- SB** Seismic Bracing



## MECHANICAL DIAGRAMS – MOUNTING & DIMENSIONS

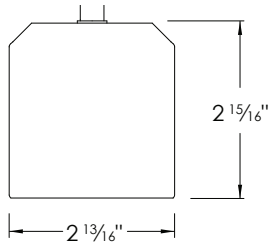

**TRPSD**  
SUSPENDED  
REMOTE DRIVER

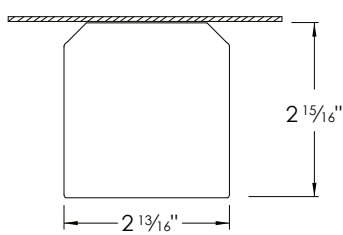

**TRPSMB**  
SURFACE/BACK MOUNT  
REMOTE DRIVER

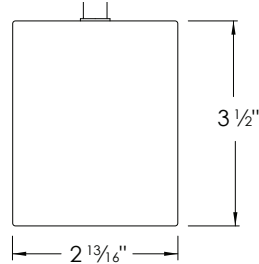

**TRPSDINT**  
SUSPENDED  
INTEGRAL DRIVER

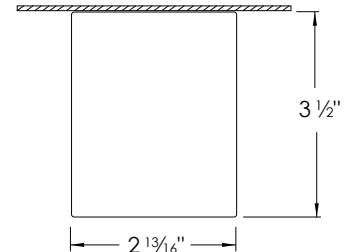

**TRPSMBINT**  
SURFACE/BACK MOUNT  
INTEGRAL DRIVER

## SUSPENSION



### CEILING HARDWARE

- (1) 4.5" canopy per power feed location,
- (1) bullet mount,
- (1) 8' aircraft cable
- (1) 2" canopy (for use with T-bar mounting) per suspension point



### COMBO CANOPY

Choose option COMBO to specify 4.5" canopies at feed locations with power feed and aircraft cable suspension mounting.

Canopy finish is always white. Contact ALW for alternate colors.

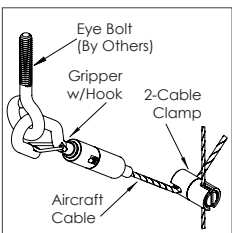

### SEISMIC BRACING

Add-on hardware includes cable gripper with hook, 2-cable clamp and specified length of aircraft cable per suspension point.



## PERFORMANCE DETAILS – LED LAMPING

OUTPUT	DELIVERED LUMENS (LM/FT)	WATTS (W/FT)	EFFICACY (LM/W)	CRI OPTIONS	CCT OPTIONS
<b>LOW<sup>5</sup></b>	730	10.3	71	80 90	3000K 3500K 4000K
<b>MED<sup>5</sup></b>	973	13.7	71		
<b>HI</b>	1216	17.1	71		
<b>DECOR<sup>5</sup></b>	324	4.4	74	N/A	2700K-5700K
<b>TUNE<sup>6,7</sup></b>	811	11.4	71		
<b>RGB<sup>7</sup></b>	Color-Changing RGB	5	N/A		80
<b>RGBW<sup>7</sup></b>	Color-Changing RGB + 4000K White	5		4000K	

<sup>5</sup>Performance calculations are extrapolated estimates based on actual performance data of HI output at 80 CRI and 3500K.

<sup>6</sup>Performance calculations are extrapolated maximum estimates for mid-range CCTs. Cooler and warmer CCTs will provide lower delivered lumens (i.e. lower lm/W, higher W/lf).

<sup>7</sup>DMX driver recommended; controller not included.

## TRIPLANE VOLTAGE DROP CHART FOR REMOTE DRIVERS - WHITE LED, 34VDC

For best performance, ensure proper wire gauge is installed between the remote LED driver and canopy that is dropping power to your fixture. This chart only applies to TRP White LEDs at 34VDC. Do not use this chart to calculate voltage drop for other fixtures.

WIRE GAUGE	20W 0.59A	30W 0.88A	40W 1.18A	50W 1.47A	60W 1.76A	70W 2.06A	80W 2.35A	90W 2.65A	100W 2.94A
<b>18 AWG</b>	127 ft.	82 ft.	59 ft.	46 ft.	37 ft.	30 ft.	25 ft.	22 ft.	19 ft.
<b>16 AWG</b>	207 ft.	135 ft.	99 ft.	78 ft.	63 ft.	53 ft.	45 ft.	39 ft.	35 ft.
<b>14 AWG</b>	335 ft.	220 ft.	163 ft.	129 ft.	106 ft.	90 ft.	77 ft.	68 ft.	60 ft.
<b>12 AWG</b>	537 ft.	355 ft.	264 ft.	210 ft.	173 ft.	147 ft.	128 ft.	113 ft.	101 ft.
<b>10 AWG</b>	859 ft.	570 ft.	425 ft.	339 ft.	281 ft.	239 ft.	208 ft.	184 ft.	165 ft.

## TRIPLANE VOLTAGE DROP CHART FOR REMOTE DRIVERS - RGB/RGBW LED, 24VDC

WIRE GAUGE	20W 0.83A	30W 1.25A	40W 1.67A	50W 2.08A	60W 2.50A	70W 2.92A	80W 3.33A	90W 3.75A	100W 4.20A
<b>18 AWG</b>	59 ft.	37 ft.	25 ft.	19 ft.	14 ft.	11 ft.	8 ft.	7 ft.	5 ft.
<b>16 AWG</b>	99 ft.	63 ft.	45 ft.	35 ft.	27 ft.	22 ft.	18 ft.	15 ft.	13 ft.
<b>14 AWG</b>	163 ft.	106 ft.	77 ft.	60 ft.	49 ft.	40 ft.	34 ft.	30 ft.	26 ft.
<b>12 AWG</b>	264 ft.	173 ft.	128 ft.	100 ft.	82 ft.	69 ft.	60 ft.	52 ft.	46 ft.
<b>10 AWG</b>	424 ft.	280 ft.	208 ft.	164 ft.	136 ft.	115 ft.	100 ft.	88 ft.	78 ft.

SS110618-A.0



## ADDITIONAL OPTIONS & SPECIFICATIONS

### ELECTRICAL PERFORMANCE

Class 2 LED drivers.  $L_{70} > 54,000$  hours.  
80+ CRI. Luminous flux +/- 5%.

### LENS

Three-side, extruded, twin-layered, high-impact acrylic. LENS is white and extra diffuse with minimal- to no-source visibility. For continuous rows, an integral steel band covers the junction where the lens edges meet.



LENS

### HOUSING

100% recyclable, extruded architectural grade 6061 aluminum with a 0.08" minimum wall thickness (for remote driver models). 18 Gauge sheet metal (for integral driver models).

### SAFETY & REGULATORY

ETL Listed (U.S. & Canada). Suitable for dry or damp locations. Certified to CSA std. C22.2#250.0:2008 Ed. 3+G1;G2.

*For integral driver models:*

Conforms to UL std. 1598, Luminaires.

*For remote driver models:*

Conforms to UL std. 2108, Low Voltage Luminaires / Low Voltage Lighting Systems

### OPERATING CONDITIONS

Luminaire should be installed and operated ONLY in dry or damp locations where the ambient temperature ranges from -4 °F to 122 °F (-20 °C to 50 °C). Luminaire operation in environments outside the listed temperature range voids the warranty AND may damage the product or adversely impact lamp life, lumen output and color consistency.

### WARRANTY

Limited 5-year warranty. Details: [alwusa.com/warranty](http://alwusa.com/warranty)

### SENSOR OPTIONS

Optional, occupancy detection (OS) and/or daylight harvesting (PS) sensor available. Or upgrade to an optional Enlighted® Smart Sensor (ENLGHT) for additional capabilities. Contact ALW for details.

### FINISH

Standard finish is "Ultimatte" aluminum — a smooth, clean, and durable finish achieved from a deep etch and two-step clear anodizing process. Other options are shown below.

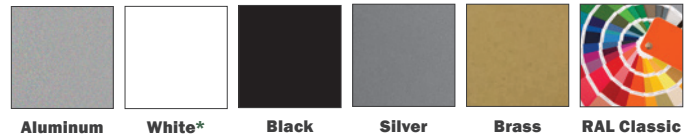

\*For healthcare environments, a white antimicrobial finish (WH/AM) is also available.