



LIGHTPLANE 1R

LP1RWWT | RECESSED WALL WASHER

STANDARD SIZES

1" Aperture Wall Washer
Configurable in straight run sections
Compatible with Drywall, T-Grid, and Slot Ceilings

LAMPING

LED - 80+ CRI - 3000K/3500K/4000K
Output Options: LOW/MED/HI/DECOR
Dimming down to 0%

FINISH

Aluminum, White, Black, Silver, Brass, RAL Classic Colors

CONSTRUCTION

Industrial Strength Extruded 6061 Aluminum





PRODUCT SUBMITTAL WORKSHEET

SAMPLE PRODUCT CODE

LP1RWWT – SLOT – S5 – HI/80/3500 – 0/10V/S – EXT – AL – UNV – EMB/1 – OS/1
 1 2 3 4 5 6 7 8 9A 9B

1. BASE MODEL

LP1RWWT 1" Recessed, Trimmed, Wall-Washer

2. CEILING TYPE (CHOOSE ONE – ADDITIONAL CEILING TYPES MAY BE AVAILABLE, CONSULT ALW)

- DRY** Drywall
- TGRID** T-Grid
- SLOT** Slot

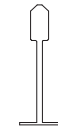

TGRID

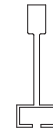

SLOT

3. LENGTH (INDICATE LENGTH IN FEET)

S__ Individual/Straight Run Section (enter length greater than 2 feet, ex. S5)

*Lengths are nominal and may vary based on lamping and other specification selections. Consult ALW when exact lengths are required.

4. LED LAMPING (CHOOSE ONE UNDER A & C)

- | | | |
|---------------------------------------|---|---------------------------------------|
| A. OUTPUT | B. CRI | C. CCT |
| <input type="checkbox"/> LOW | <input checked="" type="checkbox"/> 80 | <input type="checkbox"/> 3000K |
| <input type="checkbox"/> MED | | <input type="checkbox"/> 3500K |
| <input type="checkbox"/> HI | | <input type="checkbox"/> 4000K |
| <input type="checkbox"/> DECOR | | |

DELIVERED LUMENS (LM/FT)	WATTS (W/FT)	EFFICACY (LM/W)
See page 5 for complete details.		Up to 38 lm/W

5. REMOTE DRIVER (CHOOSE ONE)

- 0/10V/S** 0-10V dimming down to 5% (Standard Dimming – Down to 10% for DECOR lamping)
- 0/10V/1%** 0-10V dimming down to 1%
- 0/10V/0%** 0-10V premium dimming down to 0%
- DALI** DALI flicker-free dimming down to 0%
- DMX** DMX flicker-free dimming down to 0%
- ECOSYS1** Lutron Hi-lume 1% EcoSystem, constant current or constant voltage
- ECOSYS5** Lutron 5-Series 5% EcoSystem, constant current (Not available with DECOR lamping)

*Driver specifications provided upon request to assist with control system integration.

6. LENS

EXT/F Extra diffuse, flush lens

SS110618-A.0



7. FINISH (CHOOSE ONE)

- AL** Natural Anodized Aluminum (Standard Finish)
- BK** Black Powder Coat
- BRS** Brass Metallic Powder Coat
- SV** Silver Powder Coat
- WH** White Powder Coat
- WH/AM**  White Antimicrobial Powder Coat (for healthcare environments)
- RAL_____** Specify RAL Classic Color code (ex: RAL3003) ralcolorchart.com/ral-classic

8. VOLTAGE (CHOOSE ONE)

- UNV** Universal Voltage (120VAC-277VAC)
- 347** 347 Volt (Driver options may be limited)

9. ADDITIONAL OPTIONS (OPTIONAL – CHOOSE ONE UNDER A & B IF DESIRED)

A. EMERGENCY OPTIONS

- EMB/___¹** Emergency Battery (indicate quantity – each battery powers 4ft with a delivered lumen output of 649lm)
- EMC/___¹** Emergency Circuit (indicate quantity of 4ft sections to be illuminated by emergency circuit)

¹For fixtures under 4ft in length, entire fixture will be illuminated with a proportional lumen output. Consult ALW for available options.

B. SENSOR OPTIONS (COMPATIBLE ONLY WITH 0-10V DRIVERS – DEFAULT QUANTITY IS 1 SENSOR PER 8FT, INDICATE ALTERNATE QUANTITY IF DESIRED)

- ENLGHT/___²** Enlighted® remote smart sensor (occupancy, daylight, networking, and more)
- OS/___** 0-10V remote occupancy sensor
- PH/___** 0-10V remote photocell/daylight sensor

²Enlighted® Gateway and Energy Manager (by others) plus programming required. Learn more at enlightedinc.com.



MECHANICAL DIAGRAMS – FIXTURE DIMENSIONS

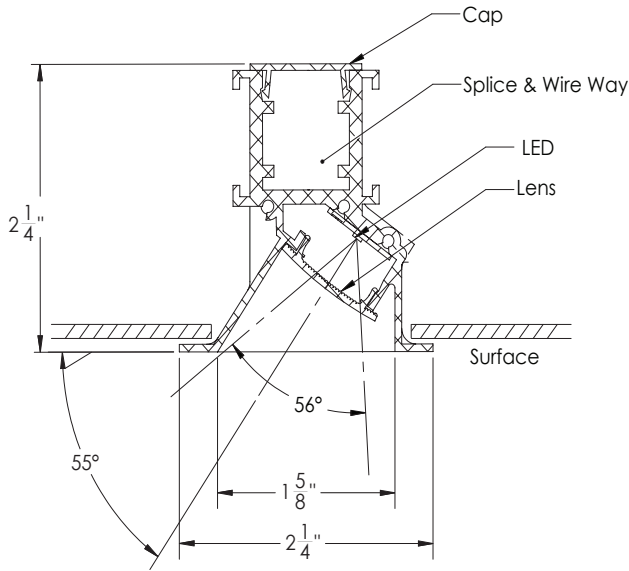

MECHANICAL DIAGRAMS – GRID CEILING DIMENSIONS

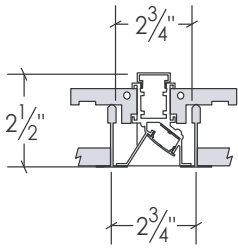

LP1RWWT
TGRID
15/16" Lay-In Tile

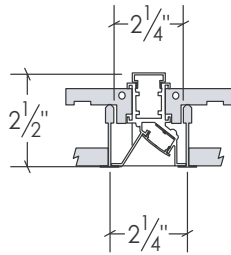

LP1RWWT
TGRID
9/16" Lay-In Tile

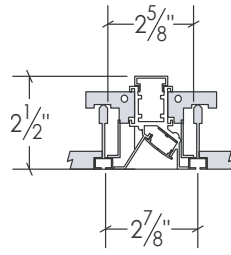

LP1RWWT
SLOT
9/16" Tegular Tile



PERFORMANCE DETAILS – LED LAMPING

OUTPUT	DELIVERED LUMENS (LM/FT)	WATTS (W/FT)	EFFICACY (LM/W)	CRI OPTIONS	CCT OPTIONS
LOW	337	8.9	38	80 90	3000K 3500K 4000K
MED	449	11.8	38		
HI	562	14.8	38		
DECOR	150	5.9	25	N/A	

*Performance calculations are based on LOW output at 80 CRI and 3500K. MED and HI calculations are extrapolated values.

LIGHTPLANE 1 VOLTAGE DROP CHART FOR REMOTE DRIVERS - WHITE LED, 28VDC

The below table should be used as a general guide to calculate the maximum run length between the canopy J-Box and the remote driver. See alwusa.com/voltage-drop-calculator/ to calculate maximum recommended run length for specific configurations. Please note that the provided values are estimates only, and may vary depending on various factors such as temperature, wire/connector quality, etc.

WIRE GAUGE	20W 0.61A	30W 0.91A	40W 1.21A	50W 1.52A	60W 1.82A	70W 2.12A	80W 2.42A	90W 2.73A	100W 3.03A
18 AWG	84 ft.	53 ft.	38 ft.	28 ft.	22 ft.	18 ft.	15 ft.	12 ft.	10 ft.
16 AWG	138 ft.	89 ft.	65 ft.	50 ft.	40 ft.	33 ft.	28 ft.	24 ft.	21 ft.
14 AWG	224 ft.	147 ft.	108 ft.	85 ft.	69 ft.	58 ft.	50 ft.	43 ft.	38 ft.
12 AWG	362 ft.	238 ft.	177 ft.	140 ft.	115 ft.	97 ft.	84 ft.	74 ft.	66 ft.
10 AWG	580 ft.	384 ft.	286 ft.	227 ft.	188 ft.	160 ft.	139 ft.	122 ft.	109 ft.



ADDITIONAL OPTIONS & SPECIFICATIONS

ELECTRICAL PERFORMANCE

LED drivers are Class 2, $L_{80} > 54,000$ hours.
80+ CRI. Luminous flux +/- 5%.

HOUSING

100% recyclable, extruded architectural grade 6061 aluminum with a 0.08" minimum wall thickness.

SAFETY & REGULATORY

ETL Listed (U.S. & Canada). Suitable for dry or damp locations. Conforms to UL std. 2108, Low Voltage Luminaires / Low Voltage Lighting Systems. Certified to CSA std. C22.2#250.0:2008 Ed. 3+G1;G2. IC (Insulation Contact) Rated.

OPERATING CONDITIONS

Luminaire should be installed and operated ONLY in dry or damp locations where the ambient temperature ranges from -4 °F to 122 °F (-20 °C to 50 °C). Luminaire operation in environments outside the listed temperature range voids the warranty AND may damage the product or adversely impact lamp life, lumen output and color consistency.

WARRANTY

Limited 5-year warranty. Details: alwusa.com/warranty

SENSOR OPTIONS

Optional, occupancy detection (OS) and/or daylight harvesting (PS) sensor available. Or upgrade to an optional Enlighted® Smart Sensor (ENLGHT) for additional capabilities. Contact ALW for details.

FINISH

Standard finish is "Ultimatte" aluminum — a smooth, clean, and durable finish achieved from a deep etch and two-step clear anodizing process. Other options are shown below.

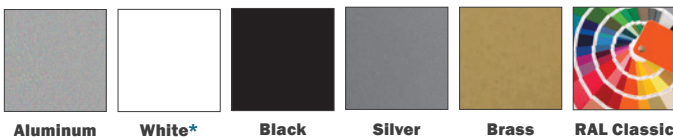

*For healthcare environments, a white antimicrobial finish (WH/AM) is also available.